

INDEX OF SHEETS	
Number	Sheet Description
COVER SHEET - NOTES AND DETAILS	
1	COVER SHEET, LOCATION MAP, INDEX OF SHEETS
2	Summary of Quantities
3	GENERAL CONSTRUCTION NOTES, STANDARD SYMBOLS, HMA SURFACE REMOVAL-BUTT JOINT DETAIL, JOINT DETAILS
4	TYPICAL CROSS SECTION, TYPICAL DRIVEWAY DETAIL, C&G DETAIL AT DRAINAGE STRUCTURE, ALLEY RETURN DETAIL-PCC PAVEMENT B'
PLAN SHEETS: HARDING AVENUE	
5	99TH STREET TO 95TH STREET STATION 0+00 TO 9+00
6	99TH STREET TO 95TH STREET STATION 9+00 TO 18+00
7	99TH STREET TO 95TH STREET STATION 18+00 TO STATION END
PLAN SHEETS: SPRINGFIELD AVENUE	
8	99TH STREET TO 95TH STREET STATION 0+00 TO STATION 9+00
9	99TH STREET TO 95TH STREET
10	99TH STREET TO 95TH STREET STATION 18+00 TO STATION END
PLAN SHEETS: AVERS AVENUE	
11	99TH STREET TO 95TH STREET STATION 0+00 TO STATION 9+00
12	99TH STREET TO 95TH STREET STATION 9+00 TO STATION 18+00
13	99TH STREET TO 95TH STREET STATION 18+00 TO STATION END
PLAN SHEETS: HAMLIN AVENUE	
14	99TH STREET TO 95TH STREET STATION 0+00 TO STATION 9+00
15	99TH STREET TO 95TH STREET STATION 9+00 TO STATION 18+00
16	99TH STREET TO 95TH STREET STATION 18+00 TO STATION END
PLAN SHEETS: RIDGEWAY AVENUE	
17	99TH STREET TO 95TH STREET STATION 0+00 TO STATION 9+00
18	99TH STREET TO 95TH STREET STATION 9+00 TO STATION 18+00
19	99TH STREET TO 95TH STREET STATION 18+00 TO STATION END
PLAN SHEETS: LAWNDALE AVENUE	
20	99TH STREET TO 95TH STREET STATION 0+00 TO STATION 9+00
21	99TH STREET TO 95TH STREET STATION 9+00 TO STATION 18+00
22	99TH STREET TO 95TH STREET STATION 18+00 TO STATION END
PLAN SHEETS: MILLARD AVENUE	
23	99TH STREET TO 95TH STREET STATION 0+00 TO STATION 9+00
24	99TH STREET TO 95TH STREET STATION 9+00 TO STATION 18+00
25	99TH STREET TO 95TH STREET STATION 18+00 TO STATION END
PLAN SHEETS: 96th STREET	
26	PULASKI AVENUE TO CENTRAL PARK AVENUE STATION 0+00 TO STATION 9+00
27	PULASKI AVENUE TO CENTRAL PARK AVENUE STATION 9+00 TO STATION 18+00
28	PULASKI AVENUE TO CENTRAL PARK AVENUE STATION 18+00 TO STATION END
PLAN SHEETS: 97th STREET	
29	PULASKI AVENUE TO CENTRAL PARK AVENUE STATION 0+00 TO STATION 9+00
30	PULASKI AVENUE TO CENTRAL PARK AVENUE STATION 9+00 TO STATION 18+00
31	PULASKI AVENUE TO CENTRAL PARK AVENUE STATION 18+00 TO STATION END
PLAN SHEETS: 98th STREET	
32	PULASKI AVENUE TO CENTRAL PARK AVENUE STATION 0+00 TO STATION 9+00
33	PULASKI AVENUE TO CENTRAL PARK AVENUE STATION 9+00 TO STATION 18+00
34	PULASKI AVENUE TO CENTRAL PARK AVENUE STATION 18+00 TO STATION END
CONSTRUCTION DETAILS	
35	MWRDC NOTES
36	FRAME AND LIDS, TYPE 1, STANDARD 604001-05
37	INLET - TYPE A
38	CATCH BASIN TYPE A STANDARD 602001-02
39	CATCH BASIN TYPE C STANDARD 602011-02
TRAFFIC CONTROL	
40	LANE CLOSURE, 2L, 2W, SHORT TIME OPERATION, STANDARD 701301-04
41	URBAN LANE CLOSURE, 2L, 2WM UNDIVIDED, STANDARD 701501-06
42	SIDEWALK, CORNER OR CROSSWALK CLOSURE, STANDARD 701801-06 SHEET 1 OF 2
43	SIDEWALK, CORNER OR CROSSWALK CLOSURE, STANDARD 701801-06 SHEET 2 OF 2
44	TRAFFIC CONTROL DEVICES, STANDARD 701901-08 SHEET 1 OF 3
45	TRAFFIC CONTROL DEVICES, STANDARD 701901-08 SHEET 2 OF 3
46	TRAFFIC CONTROL DEVICES, STANDARD 701901-08 SHEET 3 OF 3
47	TRAFFIC CONTROL AND PROTECTION FOR SIDE ROADS, INTERSECTIONS, AND DRIVEWAYS, TC-10
48	DISTRICT ONE TYPICAL PAVEMENT MARKINGS TC-13
49	DETECTOR LOOP INSTALLATIONS STANDARD 886001-01
50	TYPICAL LAYOUTS FOR DETECTION LOOPS STANDARD 886006-01

STATE OF ILLINOIS
DEPARTMENT OF TRANSPORTATION
DIVISION OF HIGHWAYS
**PROPOSED
HIGHWAY PLANS**
2022 RBI ROAD RESURFACING
MFT SECTION NO.: 22-00094-00-RS
VARIOUS STREETS
VILLAGE OF EVERGREEN PARK
COOK COUNTY

FAU RTE	SECTION	COUNTY	TOTAL SHEETS	SHEET NO.
-	22-00094-00-RS	COOK	50	1

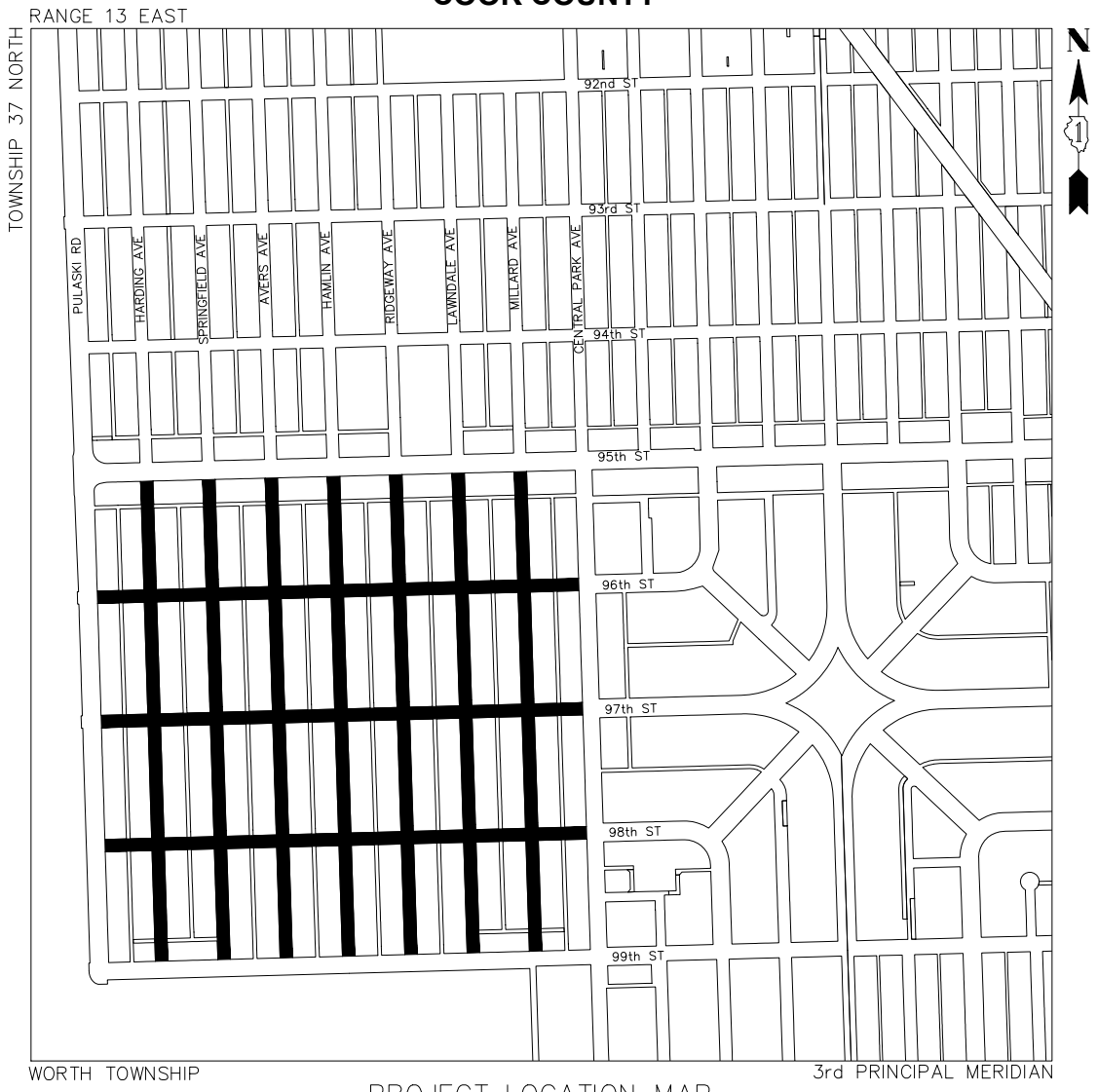
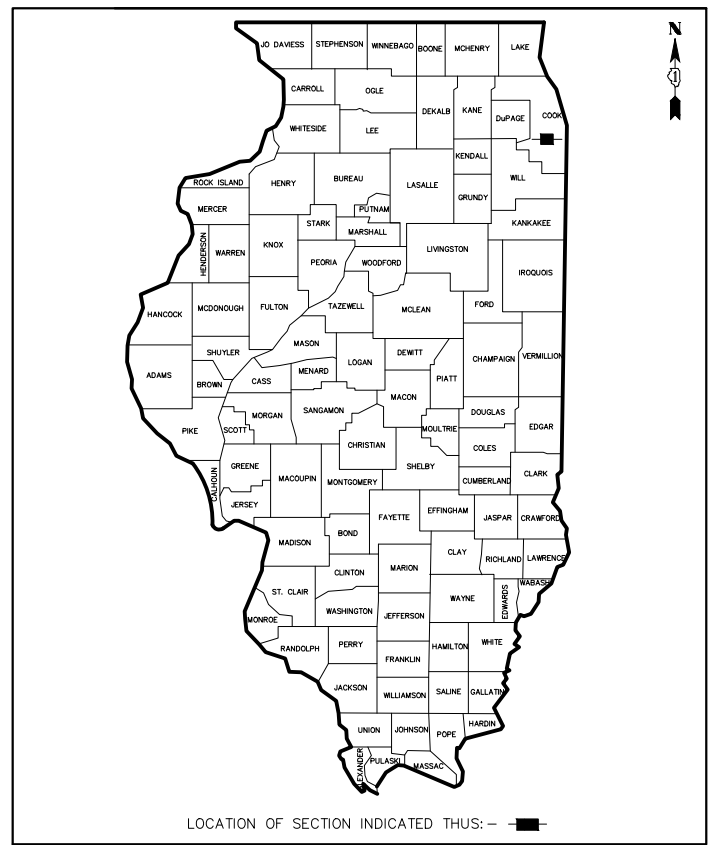

PROJECT LOCATION MAP
N.T.S.
— ■ — DENOTES LOCATION OF IMPROVEMENTS

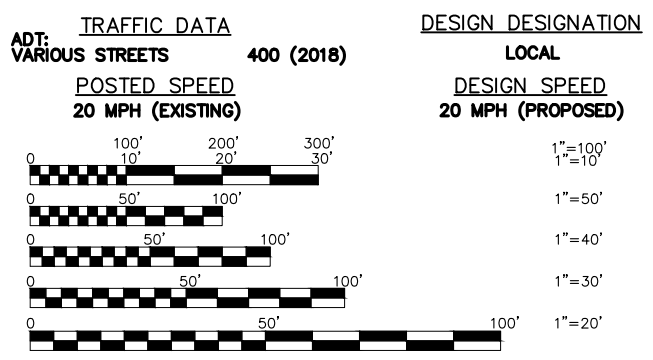

STREET	LENGTH	LENGTH OF PROJECT	
		GROSS LENGTH	NET LENGTH
HARDING AVENUE	— 99TH STREET TO 95TH STREET	= 2602 FEET (0.49 miles)	= 2602 FEET (0.49 miles)
SPRINGFIELD AVENUE	— 99TH STREET TO 95TH STREET	= 2607 FEET (0.49 miles)	= 2607 FEET (0.49 miles)
AVERS AVENUE	— 99TH STREET TO 95TH STREET	= 2610 FEET (0.49 miles)	= 2610 FEET (0.49 miles)
HAMLIN AVENUE	— 99TH STREET TO 95TH STREET	= 2608 FEET (0.49 miles)	= 2608 FEET (0.49 miles)
RIDGEWAY AVENUE	— 99TH STREET TO 95TH STREET	= 2608 FEET (0.49 miles)	= 2608 FEET (0.49 miles)
LAWNDALE AVENUE	— 99TH STREET TO 95TH STREET	= 2608 FEET (0.49 miles)	= 2608 FEET (0.49 miles)
MILLARD AVENUE	— 99TH STREET TO 95TH STREET	= 2600 FEET (0.49 miles)	= 2600 FEET (0.49 miles)
96TH STREET	— PULASKI ROAD TO CENTRAL PARK AVENUE	= 2565 FEET (0.49 miles)	= 2113 FEET (0.40 miles)
97TH STREET	— PULASKI ROAD TO CENTRAL PARK AVENUE	= 2570 FEET (0.49 miles)	= 2108 FEET (0.40 miles)
98TH STREET	— PULASKI ROAD TO CENTRAL PARK AVENUE	= 2575 FEET (0.49 miles)	= 2103 FEET (0.40 miles)
TOTAL		= 25,953 FEET (4.92 miles)	= 24,567 FEET (4.65 miles)

NOVOTNY ENGINEERING

545 Plainfield Road, Suite A
Willowbrook, IL 60527
T: (630) 887.8640
F: (630) 887.0132

Illinois Professional Design Firm No. 184-000928

FNA PROJECT NO. 21517	DRAWN/DESIGNED RAR/RAR	CHECKED/APPROVED THK/THK
-----------------------	------------------------	--------------------------

REVISIONS			
NO.	BY	DATE	DESCRIPTION
1	THK	4-11-22	PER EVERGREEN PARK
2	THK	4-11-22	REVISED TYPICAL CROSS SECTIONS

AGENCY RESPONSIBLE FOR LETTING

APPROVED MARCH 20 22

Kelly Burke

VILLAGE OF EVERGREEN PARK, VILLAGE MAYOR
KELLY BURKE

Timothy H. Klass

TIMOTHY H. KLASS, P.E.
IL. P.E. NO. 062-046111
EXPIRES 11-30-2023

MARCH 22, 2022

DATE SEAL

J.U.L.I.E.
JOINT UTILITY LOCATION INFORMATION FOR EXCAVATION
CALL 811

Know what's below.
Call before you dig.